



MENLO · BUSINESS · PARK

**PREMIUM  
R&D/OFFICE BUILDING**

Central Location

Easy Access

Flexible Modern Facilities

Award-winning Design

Quality Working Environment

Parklike, Campus Setting

Exceptional Amenities

*Exclusive agents:*



(650) 330-3600

*Come grow with us.*

**MENLO BUSINESS PARK**

**BUILDING 16**

*FDA approved clean room. Improved bio-tech lab space.*



**1505 Adams Drive, Menlo Park**

**Building 16 at Menlo Business Park** is a premium 30,240 square foot office/R&D/laboratory building, divisible into separate suites ... each with a lobby, office space, and a warehouse area. Three of the suites have wet and/or dry labs that are ideal for biotech facilities. This attractive, fully air conditioned and sprinklered building has an excellent combination of features, and tenant improvements are available.

Menlo Business Park is a 50 acre/18-building/900,000 square foot complex in a modern, carefully planned, parklike/campus environment with abundant landscaping, ample parking, and onsite food service and recreational facilities. MBP is located in a strategic Menlo Park/Mid-Peninsula location close to Stanford University and the Stanford Research Park, with easy access to all major freeways ... placing the Park just minutes from San Francisco, three international airports, the Silicon Valley, and the East Bay. Acclarent, United Parcel Service, Virobay, Vello Systems, and a variety of high technology and biotech firms make Menlo Business Park their home, creating a dynamic, growth-oriented environment.

# MENLO BUSINESS PARK



1505 Adams Drive  
Menlo Park

Flexible, functional,  
efficient configuration

High productivity environment

Highest quality management  
and tenant services



© 2011 Tarlton Properties

## A flexible, efficient, and attractive facility for an exceptional business environment.

Building 16 at Menlo Business Park is very flexible. The exterior of the building reflects the award-winning design, and the open and well-lighted interior abounds in special features ... the result is a unique R&D/laboratory facility, ideal for any company seeking a highly efficient, attractive, and productive working environment. The individual suites are especially well suited for biotech uses. Available tenant improvements provide for additional tenant-specific features.

Available: 30,240+/- sq. ft.

### First Floor:

- Suite A: 2,578+/- sq. ft.
- Suite B: 6,909+/- sq. ft.
- Suite C: 4,840+/- sq. ft.
- Suite D: 4,840+/- sq. ft.

### Second Floor:

- Suite B: 4,253+/- sq. ft.
- Suite C: 2,127+/- sq. ft.
- Suite D: 4,500+/- sq. ft.

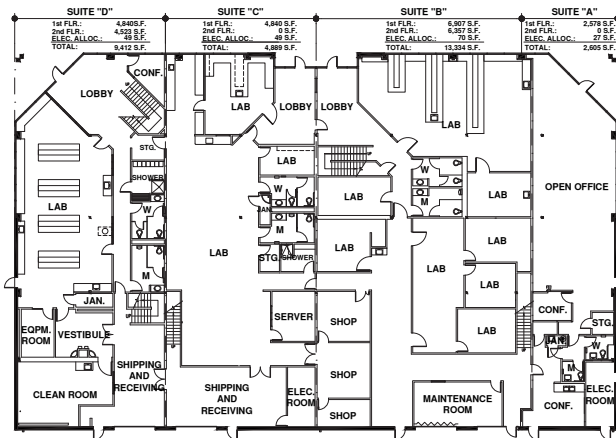

First Floor

Second Floor

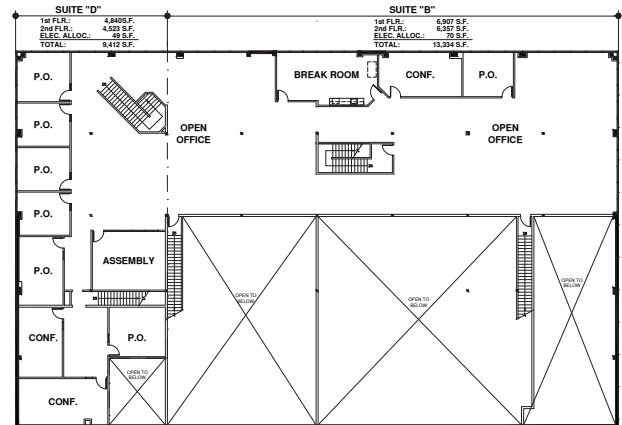

Contact John Tarlton at:



COMMERCIAL DEVELOPMENT  
& PROPERTY SERVICES

1530 O'Brien Drive, Suite C

Menlo Park, CA 94025

6650.330.3600 ■ fax 650.330.3636

JTarlton@tarlton.com